

2650 HEAD

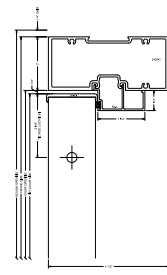

2450 HEAD

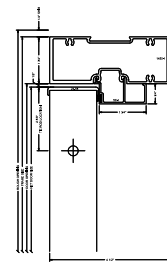

1450 HEAD

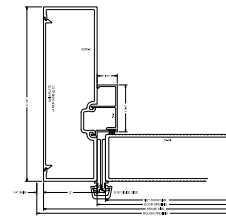

2650 HINGE JAMB

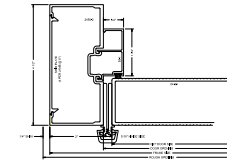

2450 HINGE JAMB

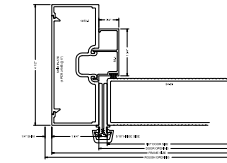

1450 HINGE JAMB

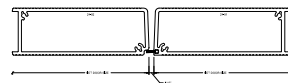

MEETING STILE PR.

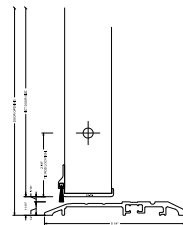

THRESHOLD

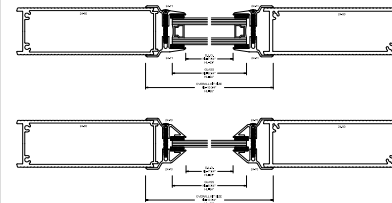

LITE KITS

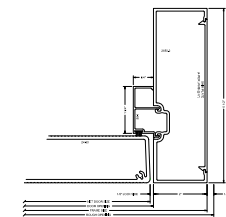

2650 LOCK JAMB

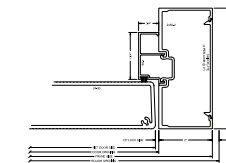

2450 LOCK JAMB

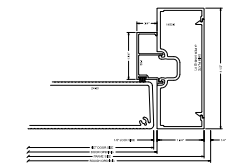

1450 LOCK JAMB

1/4 SCALE ELEVATIONS

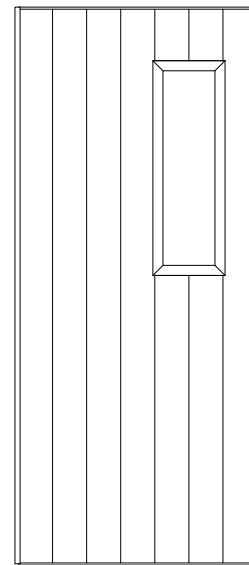
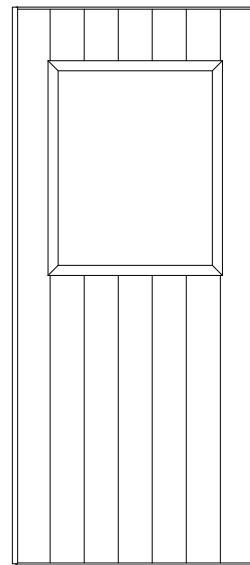
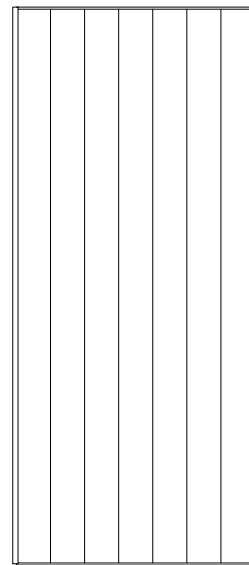

1/4 SCALE SECTIONS

FLUSH

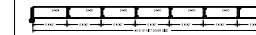

NARROW LITE

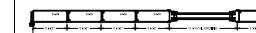

HALF LITE

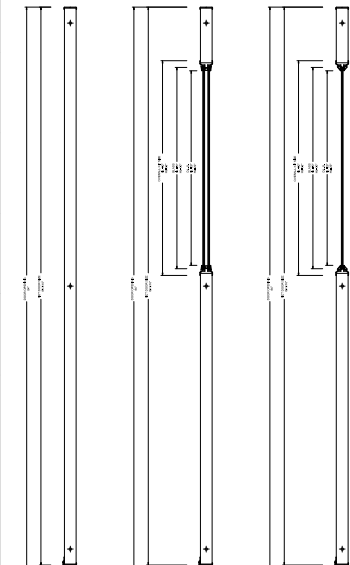
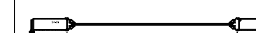

FLUSH

VISION LITE

TIE RODS LOCATED AT 2 3/8" FROM TOP OF DOOR AND BOTTOM OF DOOR. CENTER TIE ROD LOCATION VARIES TO ACCOMMODATE HARDWARE

NUPLANK DETAILS



REVISION: 12-26-17

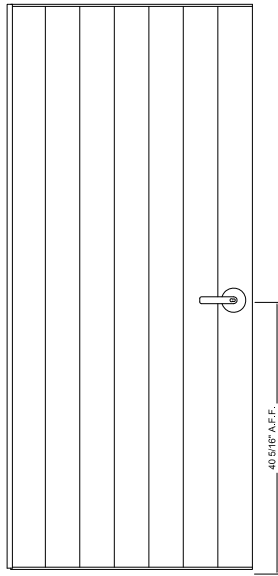

48" A.F.F.
C.L. 2 1/2" LOCK

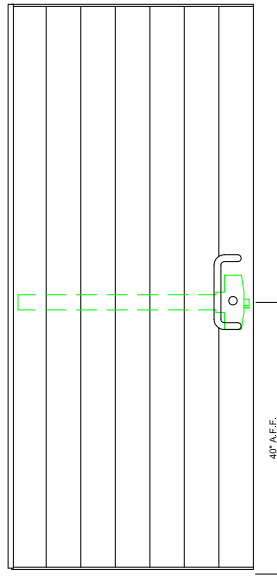

48" A.F.F.
C.L. 2" HANDLE DEVICE

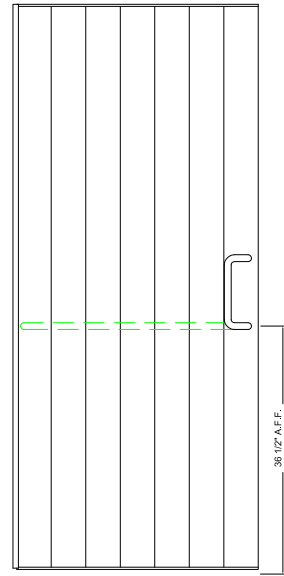

38 1/2" A.F.F.
C.L. 1 1/2" PUSH BAR

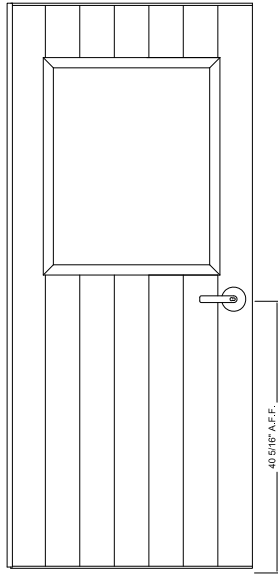

48" A.F.F.
C.L. 2 1/2" LOCK

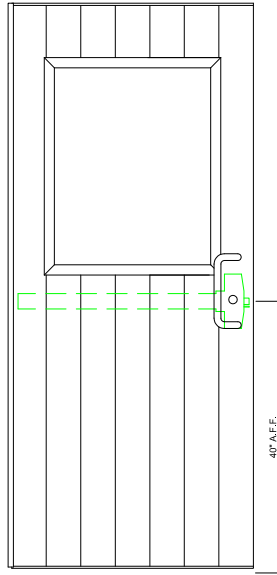

48" A.F.F.
C.L. 2" HANDLE DEVICE

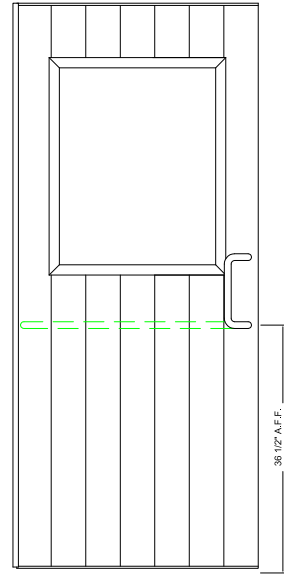

38 1/2" A.F.F.
C.L. 1 1/2" PUSH BAR

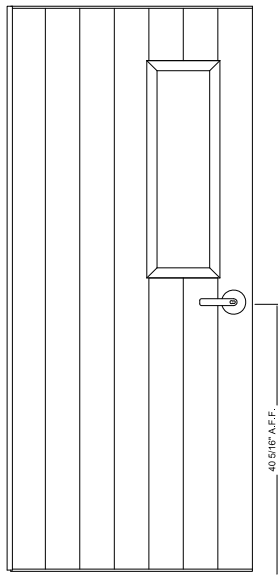

48" A.F.F.
C.L. 2 1/2" LOCK

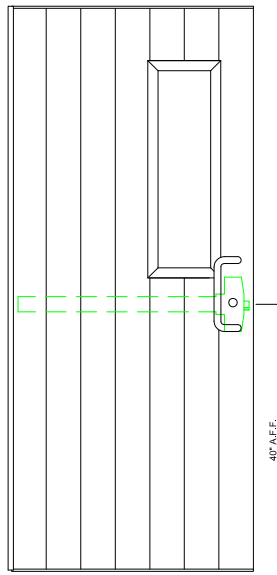

48" A.F.F.
C.L. 2" HANDLE DEVICE

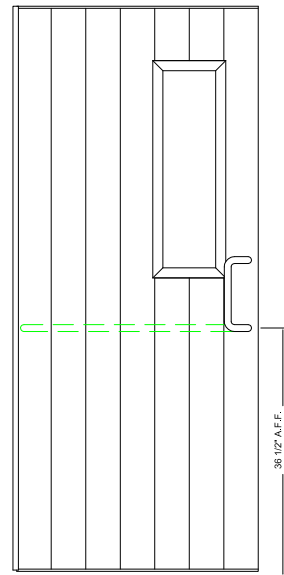

38 1/2" A.F.F.
C.L. 1 1/2" PUSH BAR

STANDARD HARDWARE LOCATIONS



1/4 SCALE ELEVATIONS

REVISION: 12-26-17